

WILKERSON®

Richland, MI 49083

Tel: (269) 629-5000

Installation & Service Instructions
83-860-000

Filter / Regulator Model CB6B with
Variations and Accessories

ISSUED: February, 2006

Supersedes: August, 2002

Doc.# 83860000, ECN# 060135, Rev. 2

WARNING

To avoid unpredictable system behavior that can cause personal injury and property damage:

- **Disconnect electrical supply (when necessary) before installation, servicing, or conversion.**
- **Disconnect air supply and depressurize all air lines connected to this product before installation, servicing, or conversion.**
- **Operate within the manufacturer's specified pressure, temperature, and other conditions listed in these instructions.**
- **Medium must be moisture-free if ambient temperature is below freezing.**
- **Service according to procedures listed in these instructions.**
- **Installation, service, and conversion of these products must be performed by knowledgeable personnel who understand how pneumatic products are to be applied.**
- **After installation, servicing, or conversion, air and electrical supplies (when necessary) should be connected and the product tested for proper function and leakage. If audible leakage is present, or the product does not operate properly, do not put into use.**
- **Warnings and specifications on the product should not be covered by paint, etc. If masking is not possible, contact your local representative for replacement labels.**

CAUTION

Polycarbonate bowls, being transparent and tough, are ideal for use with Filters and Lubricators. They are suitable for use in normal industrial environments, but should not be located in areas where they could be subjected to direct sunlight, an impact blow, nor temperatures outside of the rated range. As with most plastics, some chemicals can cause damage. Polycarbonate bowls should not be exposed to chlorinated hydrocarbons, ketones, esters and certain alcohols. They should not be used in air systems where compressors are lubricated with fire-resistant fluids such as phosphate ester and diester types.

Metal bowls are recommended where ambient and/or media conditions are not compatible with polycarbonate bowls. Metal bowls resist the action of most such solvents, but should not be used where strong acids or bases are present or in salt laden atmospheres. Consult the factory for specific recommendations where these conditions exist.

TO CLEAN POLYCARBONATE BOWLS USE MILD SOAP AND WATER ONLY! DO NOT use cleansing agents such as acetone, benzene, carbon tetrachloride, gasoline, toluene, etc., which are damaging to this plastic.

Bowl guards are recommended for added protection of polycarbonate bowls where chemical attack may occasionally occur.

WARNING

To avoid polycarbonate bowl rupture that can cause personal injury or property damage, do not exceed bowl pressure or temperature ratings. Polycarbonate bowls have a 150 PSIG pressure rating and a maximum temperature rating of 125°F.

INSTALLATION

1. Refer to Warnings and Cautions.
2. Install as close as possible to where regulated air is needed. In system with a cyclic demand, the regulator should be located upstream of cycling device.
3. Install the unit with air flowing through the body in the direction indicated by the arrow.

4. System piping should be same pipe size as regulator porting. Avoid using fittings, couplings etc., that restrict the airflow, unless maximum flow is not needed.
5. Gauge ports (1/4") are provided in either side of the regulator body for installation of a gauge or use as an additional outlet port. Plug unused port(s).
6. Before turning on the supply air pressure, turn the adjusting knob counterclockwise until there is no load on the regulating spring. Turn on the supply air pressure and then turn the adjusting knob clockwise until the desired secondary pressure is reached. When making a change in pressure setting, always approach the desired pressure from a lower one. When reducing from a higher to a lower setting, first reduce to some pressure less than that desired and then increase to the desired pressure.
7. Maximum pressure and temperature ratings for plastic bowls are 150 psig (10 bar) and 125°F (52°C); and for metal bowls, 200 psig (14 bar) and 175°F (79°C).

MAINTENANCE

1. The regulator can be disassembled for servicing without removal from line.
2. Occasionally remove bowl and bowl guard, baffle, element, adapter, valve spring and valve assembly, and clean valve assembly, body and valve seat.
3. BEFORE DISASSEMBLING-shut off air to regulator and bleed upstream and downstream pressure to 0 psig.
4. IF UNIT WILL NOT REGULATE TO DESIRED PRESSURE, IF PRESSURE BECOMES EXCESSIVE, OR IF UNIT LEAKS AT RELIEF PORT - disassemble regulator and inspect diaphragm assembly and rubber seat, valve stem and o-ring, and valve seat and o-ring in regulator body for signs of wear. Replace damaged or worn parts. Lubricate o-rings with Dow Corning 44 Silicone grease or equivalent and reassemble.
5. WHEN REPLACING DIAPHRAGM ASSEMBLY- the RRP-96-213 Diaphragm assembly is a relieving type diaphragm.

WARNING

FAILURE OR IMPROPER SELECTION OR IMPROPER USE OF THE PRODUCTS AND/OR SYSTEMS DESCRIBED HEREIN OR RELATED ITEMS CAN CAUSE DEATH, PERSONAL INJURY AND PROPERTY DAMAGE.

This document and other information from The Company, its subsidiaries and authorized distributors provide product and/or system options for further investigation by users having technical expertise. It is important that you analyze all aspects of your application, including consequences of any failure and review the information concerning the product or systems in the current product catalog. Due to the variety of operating conditions and applications for these products or systems, the user, through its own analysis and testing, is solely responsible for making the final selection of the products and systems and assuring that all performance, safety and warning requirements of the application are met.

The products described herein, including without limitation, product features, specifications, designs, availability and pricing, are subject to change by The Company and its subsidiaries at any time without notice.

EXTRA COPIES OF THESE INSTRUCTIONS ARE AVAILABLE FOR INCLUSION IN EQUIPMENT / MAINTENANCE MANUALS THAT UTILIZE THESE PRODUCTS. CONTACT YOUR LOCAL REPRESENTATIVE.

REPAIR KITS AND REPLACEMENT PARTS

Self-Relieving Repair Kit (includes self relieving diaphragm assembly, valve assembly, filter element and bowl o-ring)	CRP-95-027
Non-Relieving Repair Kit (includes nonrelieving diaphragm assembly, valve assembly, filter element and bowl o-ring)	CRP-95-028
Self-Relieving Diaphragm Assembly	RRP-96-213
Nonrelieving Diaphragm Assembly.....	RRP-96-216
Valve Assembly (valve stem, valve spring)	CRP-96-008
Regulating Springs:	
0-50 psi.....	RRP-95-222
0-125 psi.....	RRP-95-224
0-250 psi.....	RRP-95-218
Filter Element Kit (includes element and bowl o-ring)	FRP-95-160
Transparent Plastic Bowl Assemblies:	
with Flex-Drain™	FRP-95-017
with bowl guard, Auto Drain.....	FRP-95-015
with bowl guard, Flex-Drain™.....	FRP-95-014
Bowl O-ring Kit (10 per kit)	GRP-95-009
Bowl Guard Kit.....	GRP-95-013
Metal Bowl Assemblies	
with metal petcock.....	FRP-95-178
with Auto Drain (Fluorocarbon Seals).....	FRP-95-950
with Sight Gauge, metal petcock (for units with "G" in part number).....	GRP-95-133
Sight Gauge Kit	GRP-95-079
Drains:	
Automatic Drain Kit with Nitrile Seals (includes o-ring, nut).....	GRP-95-973
Brass Petcock (for metal bowls)	GRP-95-182
Flex-Drain™ Kit (for metal bowls).....	FRP-95-610
Automatic Drain Kit with Fluorocarbon Seals	GRP-95-981
Adjusting Knob Kit	RRP-95-023

ACCESSORIES

Panel Mount Nut.....	GPA-95-032
Wall Mounting Bracket with Panel Nut.....	GPA-95-011
Wall Mounting Bracket only	GPA-95-012
Tamper Resistant Kit	RPA-95-006
Gauges:	
0-60 psig.....	K4520N14060
0-160 psig.....	K4520N14160
0-300 psig.....	K4520N14300

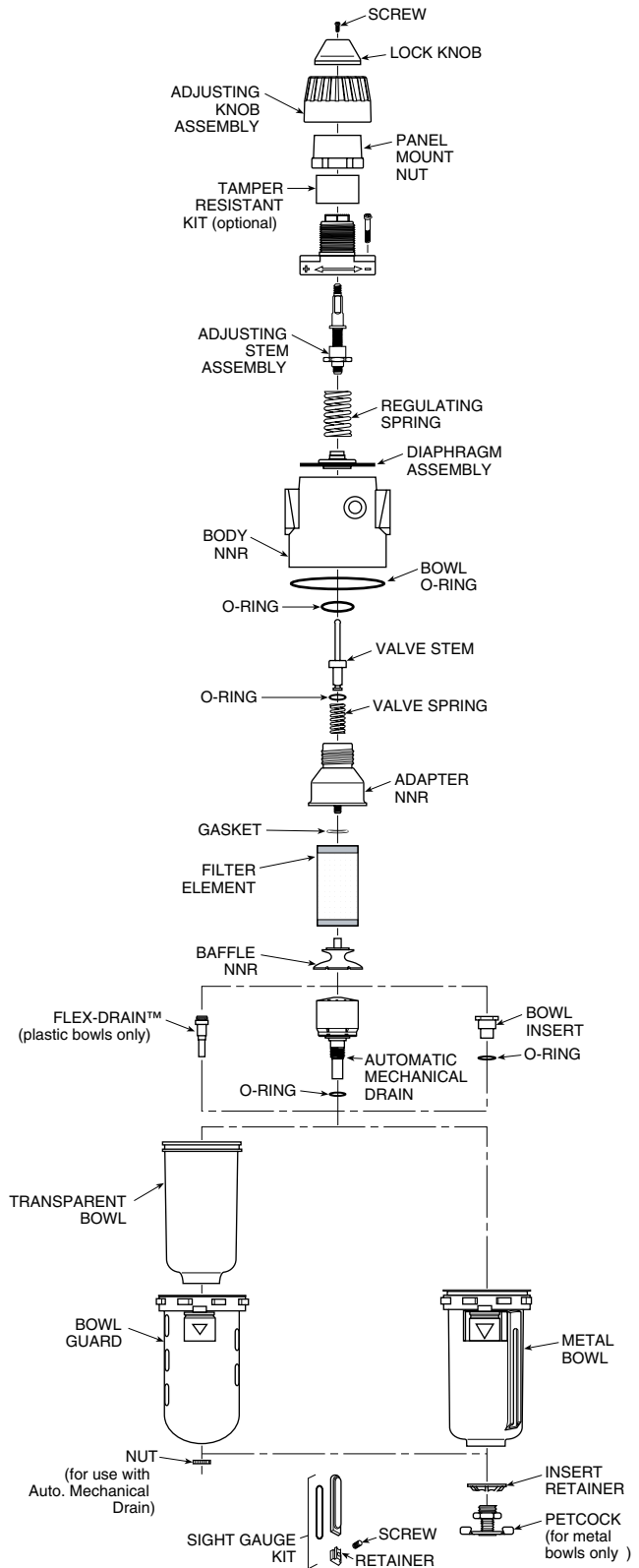

NNR = Not Normally Replaced